



Thermo-Fit Complete Custom Full-Frame Replacement Windows



1120 38th Avenue Northeast
Sauk Rapids, Minnesota 56379
Phone: 320-529-4012
Toll-Free: 1-877-565-0159
info@ttwindows.com
www.ttwindows.com



Installation innovation – inside and out.

Thermo-Fit Complete is a custom full frame replacement window that makes for much quicker and easier installations than conventional replacement windows. Like all of the Thermo-Fit replacement windows from Thermo-Tech, Thermo-Fit Complete windows are custom sized to fit. Each window arrives ready to install complete with exterior moulding and prefinished interior jamb and casing. The sturdy vinyl frame and brick mould are factory assembled and the prefinished wood interior arrives ready to slide into place.

Energy-efficient, Thermo-Fit Complete windows are available in a variety of profiles, wood choices, and finishes to match any home. They are manufactured with expert craftsmanship using only the best materials, and are backed by trained sales consultants, unmatched customer and field service, on-time delivery, and one of the best warranties in the business.



Complete window solution easy as 1-2-3.

Window is secured to exterior surface through hidden installation grooves in brick mould that is factory applied to window frame. Jamb is fitted into the factory-installed receptors, and the window casing slides securely into place to complete the installation.



Custom Features

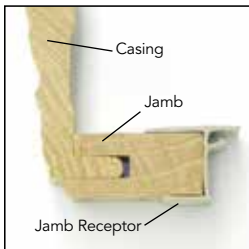

Jamb Receptor

The assembled wood jamb easily slides into jamb receptors built into the window frame.



Exterior Brick Mould

The factory attached exterior brick mould provides attractive curb-appeal on replacement projects without the hassles of extra finishing work.

Available in 1-1/2- or 2-inch widths.



Nail Fin Option

A factory attached integrated nail fin option is also available for new-construction applications.



Interior Wood Laminate

Laminates match the standard interior trim colors and feature the warmth of wood with the maintenance-free insulating power of vinyl.



Light Oak



Dark Oak

Exterior Frame Colors

Thermo-Fit Complete windows are available in three exterior colors to match virtually any home style or color.



White



Tan



Sandlewood

Interior Wood Trim

The interior wood trim is available in a variety of different profiles, wood choices, and finishes to match any home's interior. (See your dealer for complete selection.)



See the video and learn more about Thermo-Fit Complete. Visit ttwindows.com or call 877-565-0159 for more information.



Quick installation begins with a few easy measurements.

To provide multiple finishing options, Trimline brickmould is offered in 1-1/2" and 2" widths. Brickmould application is available on all four sides (picture framed), or a 1" sill nose can be substituted for either style at window base. Please visit ttwindows.com/why-thermo-tech/trimline-brick-mould for detailed configuration description.

MEASURING

STEP 1: From interior remove existing trim casing. Place a straight ruler in the gap between existing window frame and wall to measure the exact overall wall thickness (See figure 1). *Note: Some insulation may need to be temporarily removed to ensure proper measurement.*

Be sure this measurement is from the exterior surface the new window will be mounted on (usually the outside of the exterior sheathing) to the inside surface of the wall. When made this will be the measurement on your Thermo-Fit Complete unit from the back surface of the brickmould to the interior surface of the new trim casing (See figure 2).

STEP 2: On existing window, measure the outside of brickmould to outside of brickmould width and height and deduct 1/4" from each to ensure proper fit and seal. These will be the **ordering dimensions** provided to your dealer when you place your order.

SELECTING BRICKMOULD & TRIM SIZE OPTIONS

STEP 1: Note whether the current unit has brickmould all the way around (infrequent), or if there is brickmould on three sides with a sub sill at the bottom (typical).

STEP 2: With your **ordering dimensions** use the deductions in Chart A to determine the **frame dimensions** of the unit. Ensure these dimensions fit within the overall window opening (usually done from interior).

STEP 3: Using the **frame dimensions** determined in Step 2, add the measurements in Chart B to select the proper trim width required to cover interior paint lines where the old casing was removed.

Note: Using the 1-1/2" Trimline Brickmould will provide wider overall frame dimensions and wider interior casing width.

STEP 4: Provide ordering dimensions, wall depth, brickmould width and sill selection, and interior casing width to your dealer when ordering.

For questions, please feel free to contact our Customer Service team at 877-565-0159.

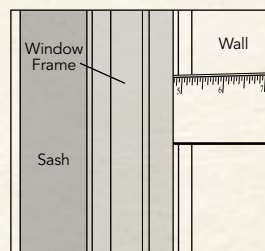

Figure 1

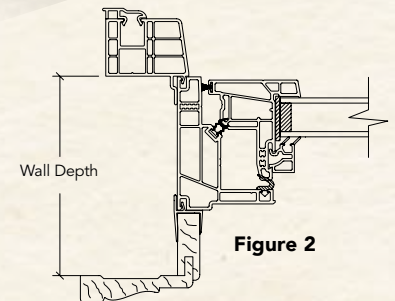

Figure 2

Chart A: Deduction from outside of brickmould to get frame dimension.

Style	Deduct Width	Deduct Height
1-1/2" Brickmould	2-5/8"	2-5/8"
1-1/2" Brickmould w/ 1" Sill	2-5/8"	2-5/16"
2" Brickmould	3-5/8"	3-5/8"
2" Brickmould w/ 1" Sill	3-5/8"	2-13/16"

Chart B: Addition to frame dimension to get outside of casing dimension.

Style	Add to Width	Add to Height
2 -1/4" Casing	3-1/2"	3-1/2"
3 -1/4" Casing	5-1/2"	5-1/2"